

## PL-CORE-TW- -1000-90

PrevaLED CORE TW | Spot-, Down- and Wallmount Light Engines and Modules



### Product family features

- Color consistency < 3 SDCM in 2700 K
- Min CRI 80 and 90
- Wide flux range 1,000-5,000 lm
- Luminous efficacy up to 140 lm/W

### Product family benefits

- Wide tunable CCT range from 2700 K to 6500 K in CRI 80 and 5000 K in CRI 90
- Targeting Human Centric Lighting (HCL)
- Separable COB (chip-on-board LED) and holder to improve assembly flexibility
- Industrial standard 19x19 and 28x28 package size to simplify design-in

### Areas of application

- Hospitality
- Retail
- Shops
- Restaurants
- Gallery
- Museums



Technical data

Electrical data

Nominal voltage	35.5 V
Type of current	DC

Photometrical data

Luminous efficacy	115 lm/W
Color rendering index Ra	90
Light color (designation)	Tunable Warm White

Light technical data

Beam angle	120 °
------------	-------

Dimensions & weight

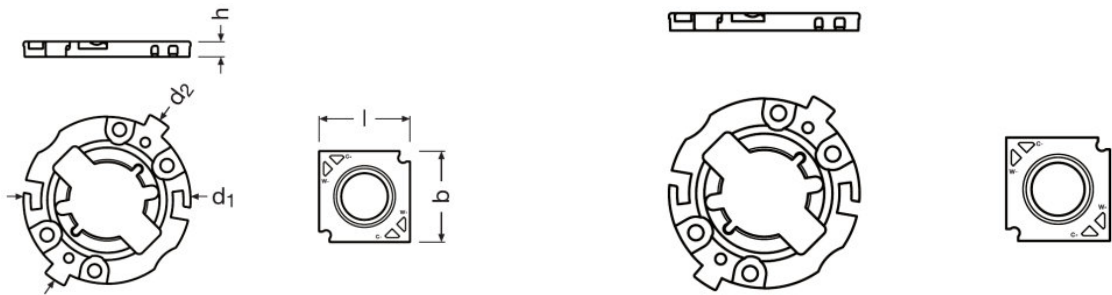

Product weight	3.20 g
----------------	--------

Temperatures & operating conditions

Performance temp. acc. to IEC 62717	25 °C
Maximum temperature at tc test point	25 °C
Temperature range at storage	-40 to 105 °C

Logistical data

Commodity code	85414100000
----------------	-------------

Environmental information

Information according Art. 33 of EU Regulation (EC) 1907/2006 (RECh)	
Date of Declaration	20-10-2022

Product datasheet

Primary Article Identifier	4062172121453
Declaration No. in SCIP database	In work

Logistical Data

Product code	Product description	Packaging unit (Pieces/Unit)	Dimensions (length x width x height)	Volume	Gross weight
4062172121453	PL-CORE-TW- -1000-90	Shipping carton box 125	214 mm x 214 mm x 96 mm	4.40 dm <sup>3</sup>	588.00 g

The mentioned product code describes the smallest quantity unit which can be ordered. One shipping unit can contain one or more single products. When placing an order, for the quantity please enter single or multiples of a shipping unit.

Disclaimer

Subject to change without notice. Errors and omission excepted. Always make sure to use the most recent release.